



Residential Generators

7.4kVA 220V  
7.4kVA 400V

Industrial Generators  
6 kVA 220V Capacitor

6 kVA 220V A.V.R  
7 kVA 400V Capacitor  
7 kVA 220V Welder Generator

**VERT ENERGY**

**POWER PRODUCTS: TECHNICAL DATA SHEETS**

VERT ENERGY GENERATORS

## ABOUT THE COMPANY

**Southern Africa's leading supplier of Electro-Mechanical Power Generation & Transmission Products**

Situated in Southern Africa's economic and industrial hub, Johannesburg, Vert Energy is well placed to service and support the region with the following range of products:

- Electric Motors and Drives
- Power Generation Products
- Portable Power Products
- Service and Support.

Make the decision and experience pure energy today.

## WATER PUMPS



## GENERATORS

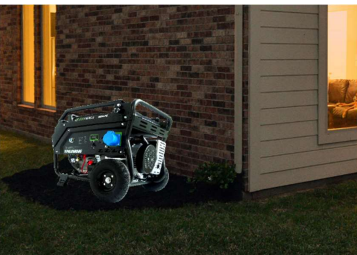

AGRICULTURE | MINING | CONSTRUCTION | RENTAL

## TRASH PUMPS



## LIGHTING TOWERS



## INDEX

## PAGE

**Residential Generator Range**

VPPHLG8000E 8 kVA 220V & Images	5 - 6
VPPHLG8000E 8 kVA 400V & Images	7 - 8

**Industrial Generator Range**

6kVA 220V Capacitor Specification Data & Drawings	9 - 10
6kVA 220V A.V.R Specification Data & Drawings	11 - 12
7kVA 220V A.V.R Specification Data & Drawings	13 - 14
7kVA 400V A.V.R Specification Data & Drawings	15 - 16
6kVA 220V 200A Specification Data & Drawings	17 - 18

**Vert Engine Specifications**

VPHL460 Specification Data & Drawings	19 - 20
---------------------------------------	---------

**NSM Alternators**

NSM K100G Specification Data & Drawings	21 - 22
NSM KR100G Specification Data & Drawings	23 - 24
NSM C100LH Specification Data & Drawings	25 - 26
NSM ZR100SC Specification Data & Drawings	27 - 28
NSM WS200AC Specification Data & Drawings	29 - 30

**Spare Parts**

31

**Contact Us**

32

Specifications subject to change without prior notice.  
E. & E.O.

## VERT ENERGY RESIDENTIAL GASOLINE GENERATORS

Model: VPP HLG8000E 220



### GASOLINE POWERED GENERATOR: OVERVIEW

8 kVA 220 V AVR

Low Fuel Consumption, High Durability, Low Noise

### Technical Features

Frequency:	50 Hz
Rated AC Output:	7.2 kVA / 3000 RPM
Maximum AC Output:	7.4 kVA / 3600 RPM 60 Hz
Power Factor:	1
AC Output Voltage:	220 V
Engine:	VPHL460
Engine Type:	Single-Cylinder, Four-Stroke, Air-Cooled, OHV Petrol Engines
Noise Level LwA Db(A)	97
Displacement:	459 cc
Maximum Output:	11.9 kW / 3600 RPM
Fuel Type:	Gasoline
Fuel Tank Capacity:	25 ltr
Continuous Work:	12 hrs
Lubrication Oil:	SAE 5W/30
Lubrication Oil Volume:	1.2 ltr
Starting Systems:	Electric start
Generator Frame:	Steel Frame with Wheels

### Packaging, Weights and Dimensions

Dimensions:	(L X W X H)	815 x 574 x 563 mm
Dry Weights:	(kg)	98

## VERT ENERGY RESIDENTIAL GASOLINE GENERATORS

Model: VPP HLG8000E 220



Operational Front View

Engine Facing Right Side View

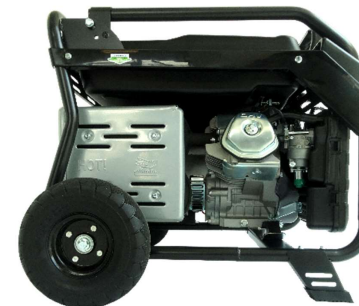

Back View

Alternator Facing Left Side



## VERT ENERGY RESIDENTIAL GASOLINE GENERATORS

Model: VPP HLG8000E 400



### GASOLINE POWERED GENERATOR: OVERVIEW

7 kVA 400 V AVR

Low Fuel Consumption, High Durability, Low Noise

### Technical Features

Frequency:	50 Hz
Rated AC Output:	7.2 kVA / 3000 RPM
Maximum AC Output:	7.5 kVA / 3600 RPM 60 Hz
Power Factor:	0.8
AC Output Voltage:	400V
Engine:	VPHL460
Engine Type:	Single-Cylinder, Four-Stroke, Air-Cooled, OHV Petrol Engines
Noise Level LwA Db(A)	97
Displacement:	459 cc
Maximum Output:	11.9 kW / 3600 RPM
Fuel Type:	Gasoline
Fuel Tank Capacity:	25 ltr
Continuous Work:	12 hrs
Lubrication Oil:	SAE 5W/30
Lubrication Oil Volume:	1.2 ltr
Starting Systems:	Electrical start
Generator Frame:	Steel Frame with Wheels

### Packaging, Weights and Dimensions

Dimensions:	(L X W X H)	815 x 574 x 563 mm
Weights:	(kg)	98

## VERT ENERGY RESIDENTIAL GASOLINE GENERATORS

Model: VPP HLG8000E 400



Operational Front View

Engine Facing Right Side View



Back View

Alternator Facing Left Side

## VERT ENERGY INDUSTRIAL GASOLINE GENERATORS

Model: VPPVG P 6000E 220V SF



### GASOLINE POWERED GENERATOR: OVERVIEW

6 kVA 220V with Capacitor

Low Fuel Consumption, High Durability, Low Noise

### Technical Features

Frequency:	50 Hz
Rated AC Output:	6 kVA / 3000 RPM
Maximum AC Output:	6 kVA / 3600 RPM 60Hz
Power Factor:	1
AC Output Voltage:	220 V
Alternator:	NSM K100G (Capacitor)
Engine:	VPHL460
Engine Type:	Single-Cylinder, Four-Stroke, Air-Cooled, OHV Petrol Engines
Noise Level @ 7m(dB)	90
Displacement:	459 cc
Maximum Output:	11.9 kW / 3600 RPM
Fuel Type:	Gasoline
Fuel Tank Capacity:	6.5 ltr
Continuous Work:	2 hrs
Lubrication Oil:	SAE 5W/30
Lubrication Oil Volume:	1.2 ltr
Starting Systems:	Recoil Start. Electric Start optional
Generator Frame:	Steel Frame

### Packaging, Weights and Dimensions

Dimensions:	(L X W X H)	815 x 498 x 548 mm
Dry Weights Recoil Start:	(kg)	67
Dry Weights Electric Start:	(kg)	67 (weight excluding battery)

## VERT ENERGY INDUSTRIAL GASOLINE GENERATORS

Model: VPPVG P 6000E 220V SF



Operational Front View



Engine Facing Right Side View

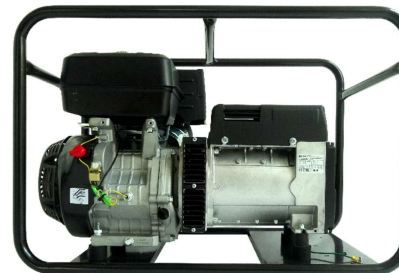

Back View



Alternator Facing Left Side

## VERT ENERGY INDUSTRIAL GASOLINE GENERATORS

Model: VPPVG P 6000E 220V AVR SF



### GASOLINE POWERED GENERATOR: OVERVIEW

6 kVA 220V with A.V.R

Low Fuel Consumption, High Durability, Low Noise

### Technical Features

Frequency:	50 Hz
Rated AC Output:	6 kVA / 3000 RPM
Maximum AC Output:	6 kVA / 3600 RPM 60Hz
Power Factor:	1
AC Output Voltage:	220 V
Alternator:	NSM KR100G (A.V.R)
Engine:	VPHL460
Engine Type:	Single-Cylinder, Four-Stroke, Air-Cooled, OHV Petrol Engines
Noise Level @ 7m(dB)	90
Displacement:	459 cc
Maximum Output:	11.9 kW / 3600 RPM
Fuel Type:	Gasoline
Fuel Tank Capacity:	6.5 ltr
Continuous Work:	~2 hrs
Lubrication Oil:	SAE 5W/30
Lubrication Oil Volume:	1.2 ltr
Starting Systems:	Recoil Start. Electric Start Optional
Generator Frame:	Steel Frame

### Packaging, Weights and Dimensions

Dimensions:	(L X W X H)	815 x 498 x 548 mm
Dry Weights Recoil Start:	(kg)	67
Dry Weights Electric Start:	(kg)	67 (weight excluding battery)

## VERT ENERGY INDUSTRIAL GASOLINE GENERATORS

Model: VPPVG P 6000E 220V AVR SF



Operational Front View



Engine Facing Right Side View

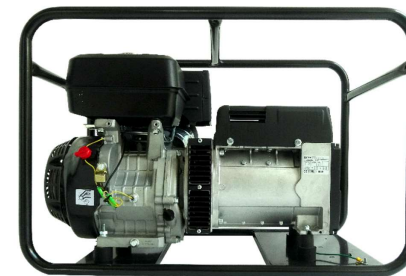

Back View



Alternator Facing Left Side

## VERT ENERGY INDUSTRIAL GASOLINE GENERATORS

Model: VPPVG P 7000M 220V SF



### GASOLINE POWERED GENERATOR: OVERVIEW

7 kVA 220V with Capacitor

Low Fuel Consumption, High Durability, Low Noise

### Technical Features

Frequency:	50 Hz
Rated AC Output:	7 kVA / 3000 RPM
Maximum AC Output:	7 kVA / 3600 RPM 60 Hz
Power Factor:	0.8
AC Output Voltage:	220 V
Alternator:	NSM C100LH (Capacitor)
Engine:	VPHL460
Engine Type:	Single-Cylinder, Four-Stroke, Air-Cooled, OHV Petrol Engines
Noise Level @ 7m(dB)	90
Displacement:	459 cc
Maximum Output:	11.9 kW / 3600 RPM
Fuel Type:	Gasoline
Fuel Tank Capacity:	6.5 ltr
Continuous Work:	1 hr 40 min
Lubrication Oil:	SAE 5W/30
Lubrication Oil Volume:	1.2 ltr
Starting Systems:	Recoil Start. Electric Start Optional
Generator Frame:	Steel Frame

### Packaging, Weights and Dimensions

Dimensions:	(L X W X H)	815 x 498 x 548 mm
Dry Weights Recoil Start:	(kg)	67
Dry Weights Electric Start:	(kg)	67 (weight excluding battery)

## VERT ENERGY INDUSTRIAL GASOLINE GENERATORS

Model: VPPVG P 7000M 220V SF



Operational Front View

Engine Facing Right Side View

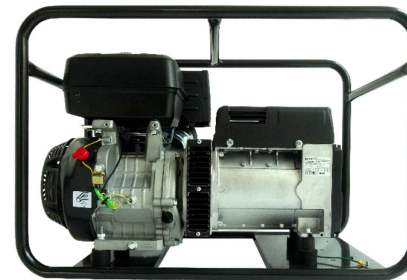

Back View

Alternator Facing Left Side

## VERT ENERGY INDUSTRIAL GASOLINE GENERATORS

Model: VPPVG P 7000M 400V AVR SF



### GASOLINE POWERED GENERATOR: OVERVIEW

7 kVA 400V with A.V.R

Low Fuel Consumption, High Durability, Low Noise

### Technical Features

Frequency:	50 Hz
Rated AC Output:	7 kVA / 3000 RPM
Maximum AC Output:	7 kVA / 3600 RPM 60 Hz
Power Factor:	0.8
AC Output Voltage:	400 V
Alternator:	NSM ZR100SC (A.V.R)
Engine:	VPHL460
Engine Type:	Single-Cylinder, Four-Stroke, Air-Cooled, OHV Petrol Engines
Noise Level @ 7m(dB)	90
Displacement:	459 cc
Maximum Output:	11.9 kW / 3600 RPM
Fuel Type:	Gasoline
Fuel Tank Capacity:	6.5 ltr
Continuous Work:	1 hr 40 min
Lubrication Oil:	SAE 5W/30
Lubrication Oil Volume:	1.2 ltr
Starting Systems:	Recoil Start. Electric start Optional
Generator Frame:	Steel Frame

### Packaging, Weights and Dimensions

Dimensions:	(L X W X H)	815 x 498 x 548 mm
Dry Weights Recoil Start:	(kg)	67
Dry Weight Electrical Start:	(kg)	67 (Excluding Battery)

## VERT ENERGY INDUSTRIAL GASOLINE GENERATORS

Model: VPPVG P 7000M 400V AVR SF



Operational Front View



Engine Facing Right Side View

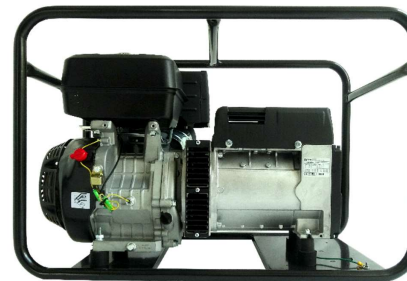

Back View



Alternator Facing Left Side



## VERT ENERGY INDUSTRIAL GASOLINE WELDER GENERATORS

Model: VPPVGW P 6000E 220V 200A SFW



### GASOLINE POWERED WELDER GENERATOR: OVERVIEW

7 kVA 220 V

Low Fuel Consumption, High Durability

### Technical Features

Maximum Rated Current:	200 A
Rated AC Output:	7.2 kVA / 3000 RPM
Power Factor:	1
Welding Voltage:	45 - 60 V
AC Voltage:	220 V
Alternator:	NSM WS200AC
Engine:	VPHL460
Engine Type:	Single-Cylinder, Four-Stroke, Air-Cooled, OHV Petrol Engines
Displacement:	459 cc
Maximum Output:	7 kVA / 3600 RPM
Fuel Type:	Gasoline
Fuel Tank Capacity:	6.5 ltr
Lubrication Oil:	SAE 5W/30
Oil Capacity:	1.2 ltr
Starting Systems:	Recoil Start. Electrical Start Optional
Welder Frame:	Steel Frame with Wheels

### Packaging, Weights and Dimensions

Dimensions:	(L X W X H)	815 x 493 x 726 mm
Handle Length (not included in above measurements):		146 mm
Dry Weights:	(kg)	88

## VERT ENERGY INDUSTRIAL GASOLINE WELDER GENERATORS

Model: VPPVGW P 6000E 220V 200A SFW

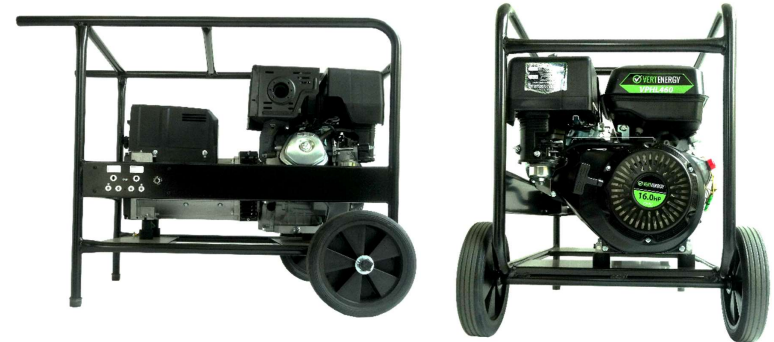

Operational Front View

Engine Facing Right Side View

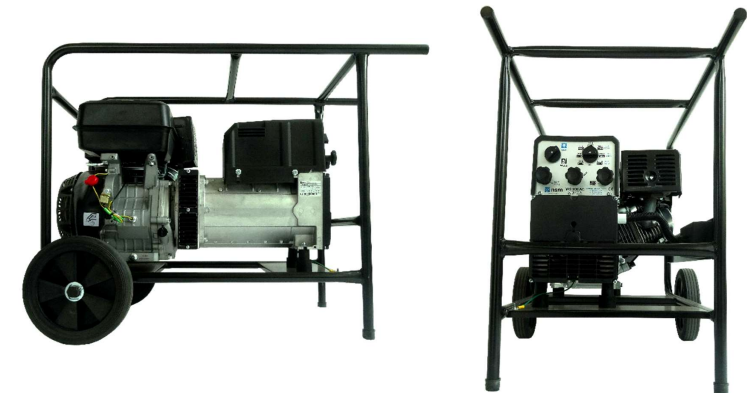

Back View

Alternator Facing Left Side

## VERT ENERGY GASOLINE ENGINES

Model: PEVPP VPHL460E GS



## GASOLINE ENGINES: OVERVIEW

VP HL460 11.9 kW (16 HP)

Low Fuel, Portable & Environmentally Friendly

## Technical Features

Engine Model:	VPHL460
Engine Type:	Single-cylinder, Four-Stroke, Air-cooled, OHV Gasoline Engine
Bore x Stroke:	92 x 69 mm
Displacement:	459 cc
Maximum Output:	11.9 kW / 3600 RPM
Fuel Consumption:	≤370 (g/kwh)
Ignition System:	Transistorized Magneto Ignition
Spark Plug:	FTTC
Fuel Tank Capacity:	6.5 ltr
Lubrication Oil:	SAE 5W/30
Lubrication Oil Volume:	1.2 ltr
Starting System:	Recoil or Electric Starter
Stop System:	Ignition Primary Circuit Ground
Noise Level:	@ 7m(dB) 90

## Mounting Configurations

Standard	J609B Tapered Shaft
----------	---------------------

## Packaging, Weights and Dimensions

Dimensions:	(L X W X H)	545 x 505 x 515 mm
Dry Weights Recoil Start:	(kg)	33
Dry Weights Electric Start:	(kg)	35

## VERT ENERGY GASOLINE ENGINES

Model: PEVPP VPHL460E GS

## DRAWIING

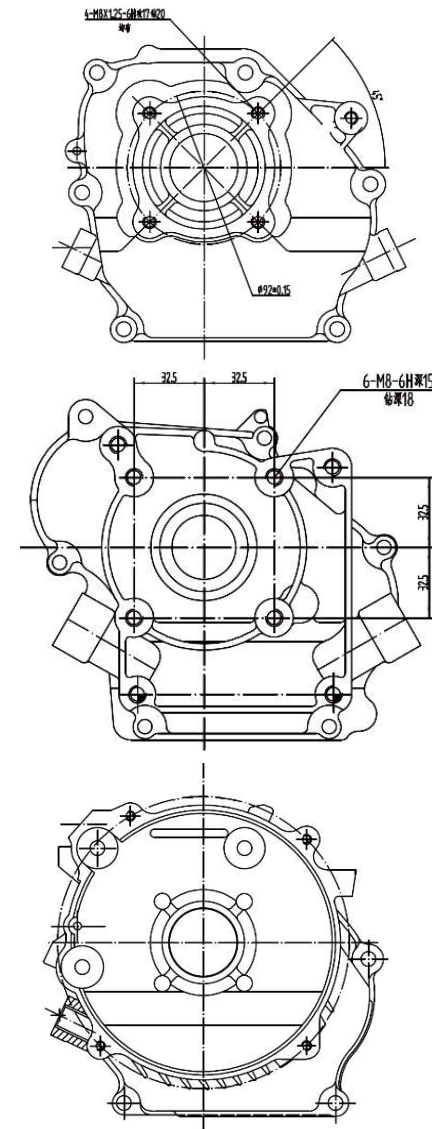

## NSM 2 Pole 6kVA

Model: K100G

## SINGLE PHASE CAPACITOR



### SINGLE-PHASE ALTERNATORS 2 POLE: OVERVIEW

K100G 6kVA

Brushless, with capacitor

#### Technical Features

Power Range (Elec) 50hz:	6 kVA (Prime Rated)
Power Range (Mech) 50hz:	7.3 kW Input Power @ 76% Efficiency (Prime Rated) pF 1.0
Standard Voltages 50hz:	220 V / 240V
Voltages Accuracy:	± 2% (regardless of cosφ)
Insulation Class:	Class "H"
Protection:	IP23
T.H.D.:	<6%
Good Starting Capacity:	(Icc >3In)

#### Mounting Configurations

Standard	J609B Taper Shaft
----------	-------------------

#### Packaging, Weights and Dimensions

Dimensions:	(L X W X H)	345 x 213 x 213
Weight:	(kg)	25

## NSM 2 Pole 6kVA

Model: K100G

## DRAWINGS

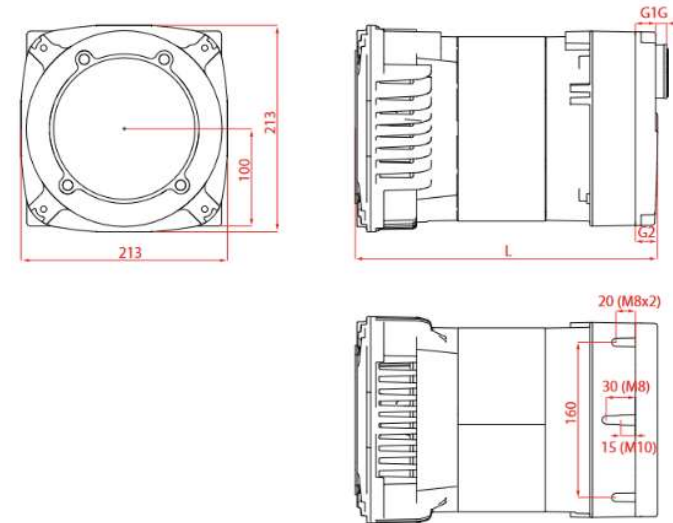

### J609b

C 22

C 25,4

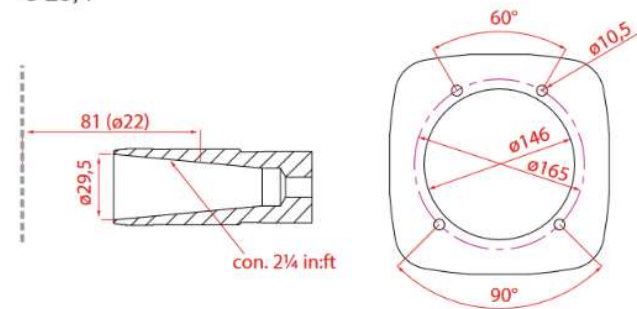

## NSM 2 Pole 6kVA

Model: KR100G

## SINGLE PHASE AVR



### SINGLE-PHASE ALTERNATORS 2 POLE: OVERVIEW

#### KR100G 6 kVA

Brush, with Automatic Voltage Regulator

#### Technical Features

Power Range (Elec) 50hz:	6 kVA (Prime Rated)
Power Range (Mech) 50hz:	7.8 kW Input Power @ 77% Efficiency (Prime Rated) pF 1.0
Standard Voltages 50hz:	230 V / 240 V
Voltages Accuracy:	-5%, -10% (cosφ = 1)
Insulation Class:	Class "H"
Protection:	IP23
T.H.D:	<6%
Good Starting Capacity:	(Icc >3In)
Automatic Voltage Regulator:	AVR520

#### Mounting Configurations

Standard	J609B Taper Shaft
----------	-------------------

#### Packaging, Weights and Dimensions

Dimensions:	(L X W X H)	392 x 213 x 213
Weight:	(kg)	25

## NSM 2 Pole 6kVA

Model: KR100G

## DRAWINGS

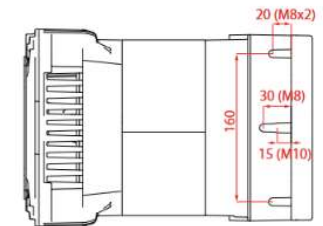
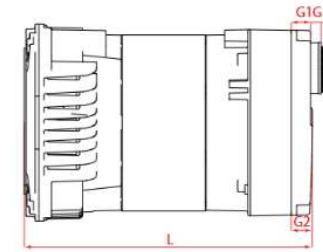
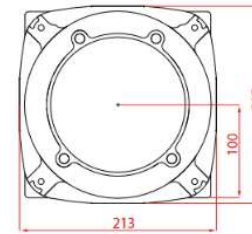

### J609b

C 22  
C 25,4

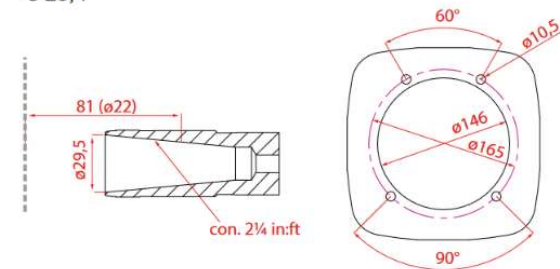



## NSM 2 Pole 7kVA

Model: C100LH

## SINGLE PHASE CAPACITOR



### SINGLE-PHASE ALTERNATORS 2 POLE: OVERVIEW

#### C100LH 7kVA

Brushless, with capacitor

#### Technical Features

Power Range (Elec) 50hz:	7 kVA (Prime Rated)
Power Range (Mech) 50hz:	9 kW Input Power @ 78% Efficiency (Prime Rated) pF 1.0
Standard Voltages 50hz:	230 V / 240 V
Voltages Accuracy:	-5%, -10% (cosφ = 1)
Insulation Class:	Class "H"
Protection:	IP23
T.H.D:	<6%
Good Starting Capacity:	(Icc >3In)

#### Mounting Configurations

Standard	J609B Taper Shaft
----------	-------------------

#### Packaging, Weights and Dimensions

Dimensions:	(L X W X H)	410 x 225 x 280
Weight:	(kg)	30

## NSM 2 Pole 7kVA

Model: C100LH

## DRAWINGS

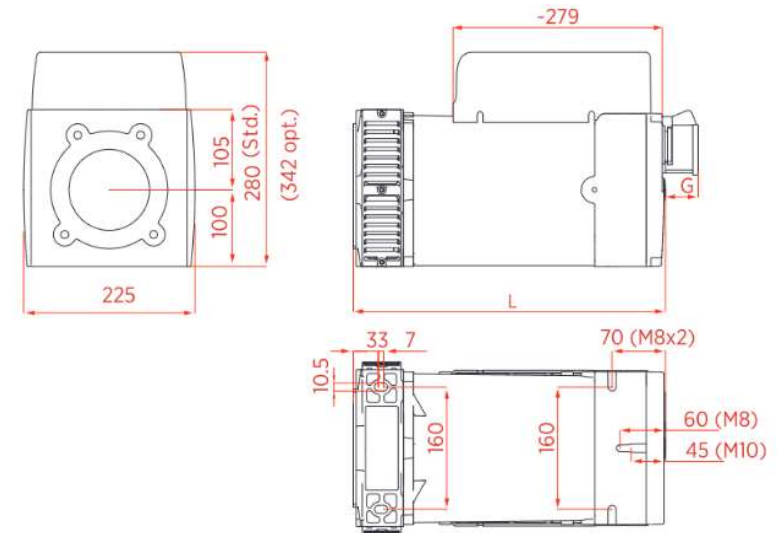

### J609b

C 22  
C 25,4  
C 35

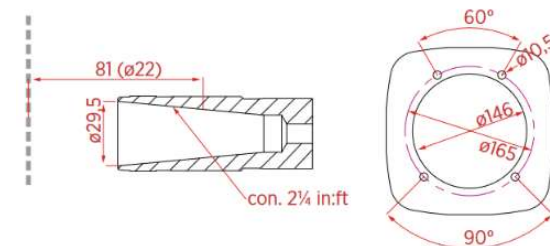

## NSM 2 Pole 7kVA

Model: ZR100SC

## THREE PHASE WITH AVR



### THREE-PHASE ALTERNATORS 2 POLE: OVERVIEW

ZR100SC 7kVA A.V.R

Brushless, with Automatic Voltage Regulator

### Technical Features

Power Range (Elec) 50hz:	7 kVA (Prime Rated)
Power Range (Mech) 50hz:	6.9 kW Input Power @ 81% Efficiency (Prime Rated) pF 0.8
Standard Voltages 50hz:	230 V / 400 V
Voltages Accuracy:	± 6% (cos φ = 0,9)
Insulation Class:	Class "H"
Protection:	IP23
T.H.D:	<6%
Good Starting Capacity:	(Icc >4In)
Automatic Voltage Regulator:	AVR960D

### Mounting Configurations

Standard	J609B Taper Shaft
----------	-------------------

### Packaging, Weights and Dimensions

Dimensions:	(L X W X H)	345 x 225 x 342
Weights	(kg)	27

## NSM 2 Pole 7kVA

Model: ZR100SC

## DRAWINGS

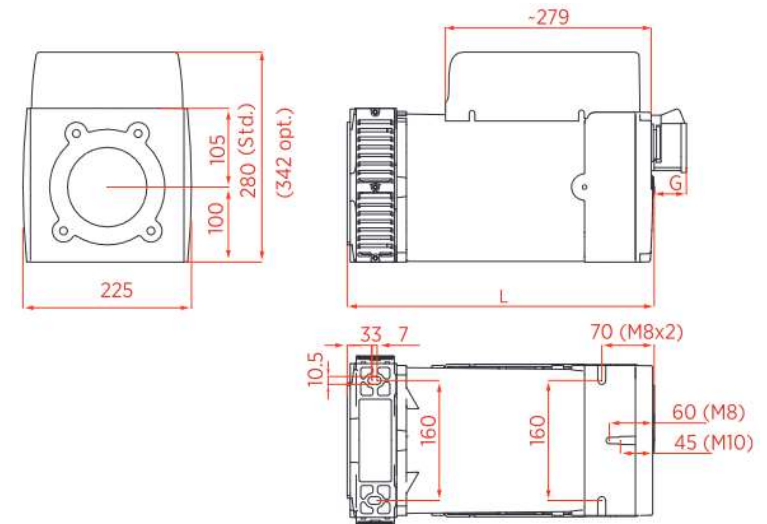

### J609b

C 22  
C 25,4  
C 35

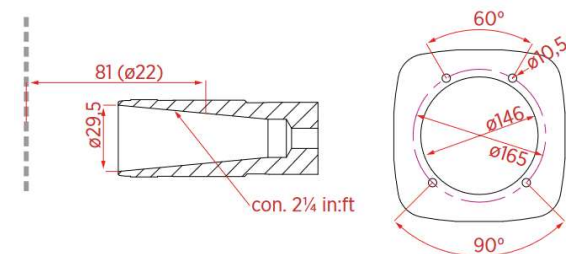

## NSM 2 Pole 7kVA

Model: WS200AC

## WELDER GENERATOR



### SINGLE-PHASE ALTERNATORS 2 POLE: OVERVIEW

WS200AC 7kVA

Brushless Alternator

### Technical Features

Power Range (Elec) 50hz:	7 kVA (Prime Rated)
Welding Current > Driving Power:	180A (ø-4mm) > 7.5 kW (10HP) 200A (ø-4mm) > 9.0 kW
Duty:	180A - 60%, 200A - 35%
Strike Voltages:	45 - 60 V
Insulation Class:	Class "H"
Protection:	IP23
T.H.D:	<6%

### Mounting Configurations

Standard	J609B Taper Shaft
----------	-------------------

### Packaging, Weights and Dimensions

Dimensions:	(L X W X H)	410 x 225 x 342
Weight:	(kg)	44

## NSM 2 Pole 7kVA

Model: WS200AC

## DRAWINGS

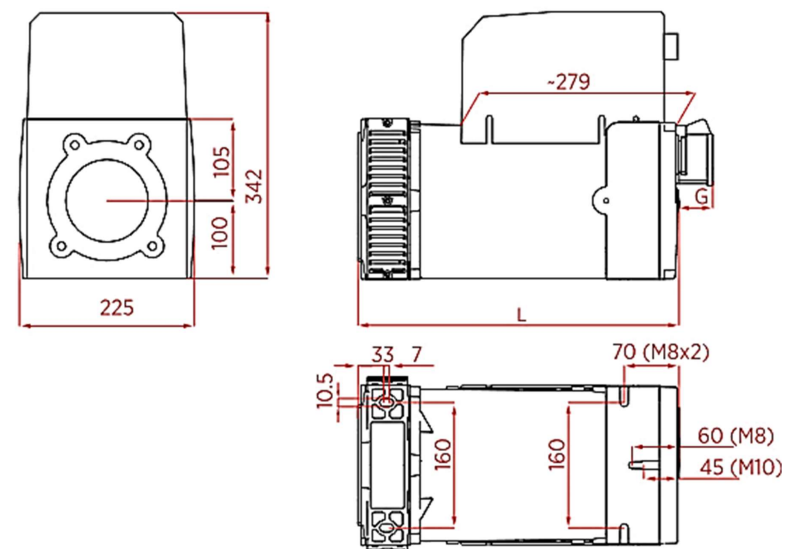

### J609b

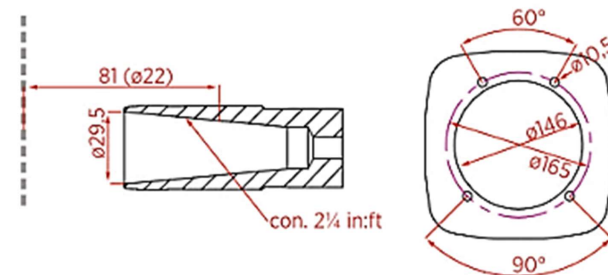
 C 22  
C 25,4  
C 35

## SPARE PARTS

Full range of Vert Energy spare parts available



## VERT ENERGY AFRICA

Head Office  
11 Voyager Street  
Linbro Park, Sandton  
Johannesburg

Contact: [info@vertgroup.co.za](mailto:info@vertgroup.co.za)

Phone: +27 11 453 9669  
Fax: +27 11 453 4531

